

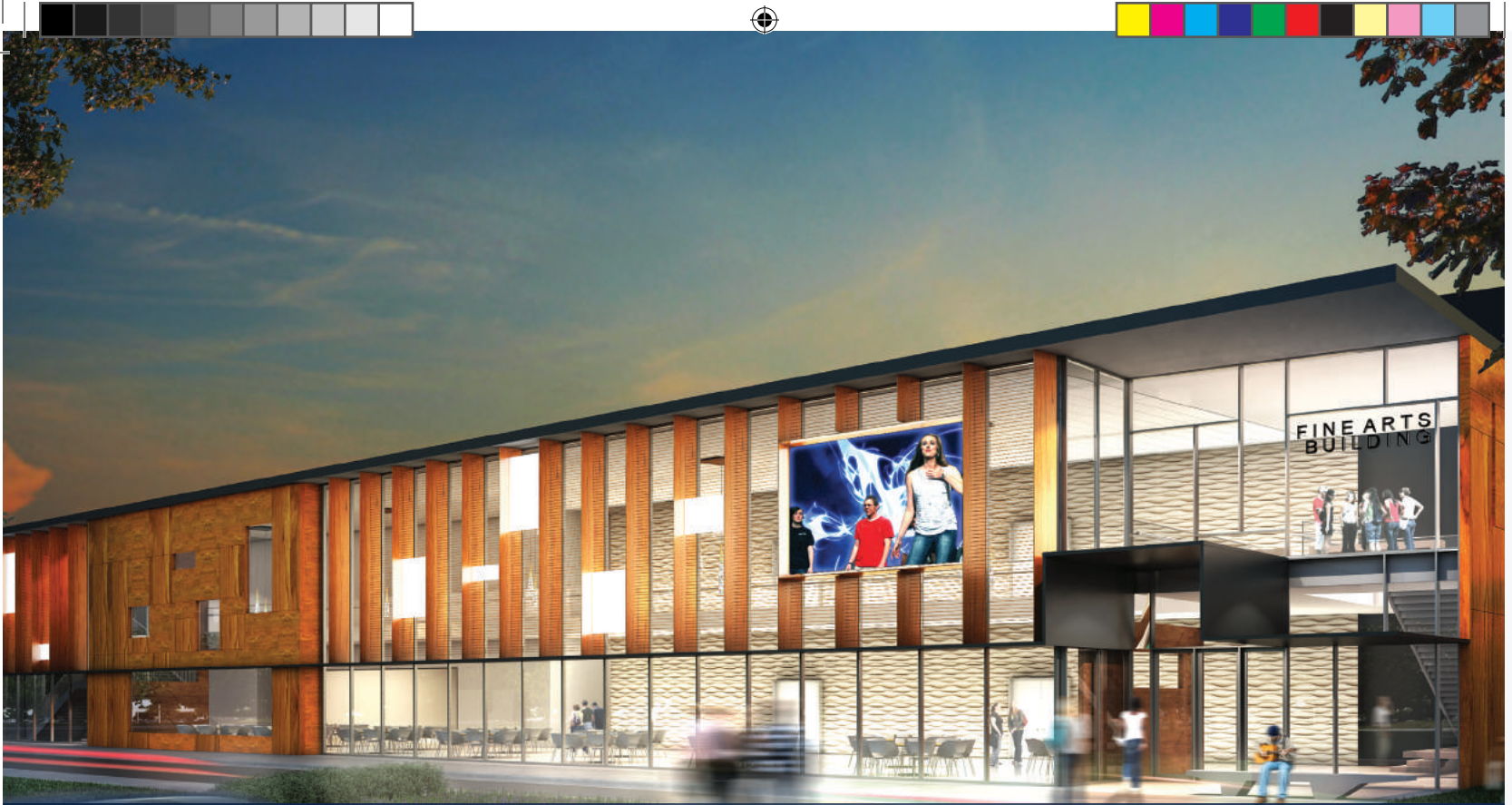

THE MACS FINE ARTS CENTER AT CHARLOTTE CATHOLIC HIGH SCHOOL

CASE STATEMENT



OUR MISSION

The mission of Mecklenburg Area Catholic Schools (MACS) is to proclaim the Good News of the Gospel and to develop each student spiritually, intellectually, physically, and socially to live in a changing society.





THE MACS FINE ARTS CENTER AT
CHARLOTTE CATHOLIC HIGH SCHOOL

CCHS LEADERSHIP

Kurt Telford

Principal

Sally McArdle

Executive Director of Advancement

DIOCESAN LEADERSHIP

Jim Kelley

Development Director

HONORARY CHAIRS

Sister Paulette Williams

CCHS Principal 1980-2000

Norm George

Mary Ann Grace

Jim Keffer

Joan & Stanley F. Michalski, Jr.

Kathy Mulvaney

Joan & Paul Polking

Jim Sigman

GENERAL CHAIRS

Carolyn Culicerto Corsi

& John Corsi

Rich Hoeftling

Tish & Brian Macuga

CAMPAIGN CABINET

Jay Bryson

Lennie Cox

Donna & Gary Green

Cindy Grim

Katie & Bryan Hodgins

Benne Hutson

Eric Kammerer

Steffan & Chris Kelly

Paul Peralta

Shannon Roderick

Sara Garces Roselli

Leslie Tesch

London & Doug Thornton

CAMPAIGN COUNSEL

Steier Group

Dear Friends,

I write today to thank you for your ongoing support of our Catholic schools and to share some plans that will benefit the entire Catholic community in Charlotte. The education of the children in our Catholic schools is a collaborative effort among the parishes, the school system, and our families, and we are committed to growing this partnership for decades to come.

With your help and continued participation, our schools have renewed our determination and commitment to build a 21st century fine arts center and create additional academic and athletic areas in the existing building at Charlotte Catholic High School. The positive results of the campaign planning study indicate that our Catholic community is ready to join us as we address these urgent needs and provide this vital expansion. Honoring our commitment to the future, our diocesan, MACS, and Charlotte Catholic leaders are now ready to officially launch *Expanding the Vision, Honoring the Tradition* – A MACS Campaign for Charlotte Catholic High School.

We are excited about this next chapter in the history of our Catholic community. Plans for the two-story MACS Fine Arts Center include an auditorium as well as visual and performing arts classrooms. All fine arts classes will relocate to this new building, freeing up existing spaces that will be renovated for athletic and academic use. The new fine arts center will serve not only as a place for learning and growth for our high school students, but also as a place for educational programs and performances for the elementary and middle school students. In addition, this beautiful new building will offer tremendous opportunity for gatherings for our entire Catholic community.

I encourage your participation in this momentous endeavor and invite you to take your place with the many families throughout our history who have supported our Catholic schools. I look forward to your continued partnership in our mission. Through your prayers, encouragement, and financial support, we are certain to succeed.

Thank you for your consideration.

Sincerely,

Kurt Telford
CCHS Principal

Charlotte Catholic High School • 7702 Pineville-Matthews Road • Charlotte, NC 28226



MECKLENBURG AREA CATHOLIC SCHOOLS

In 1992, the Charlotte-area parish schools consolidated into the Mecklenburg Area Catholic Schools system to improve the quality of education our children receive and ensure that an outstanding Catholic education is available to more children in our community.

Before the formation of MACS, the Catholic schools in Mecklenburg County were:

- Charlotte Catholic High School (9-12)
- Our Lady of the Assumption (K-8)
- Our Lady of Consolation (K-8)
- St. Gabriel (K-8)
- St. Patrick (K-8)
- St. Ann (K-8)

Our school system has seen enrollment grow from 2,420 original students to more than 4,634 students this year. Today, we are a school system of nine Catholic schools, serving grades PK through 12 in Mecklenburg County. Our schools are co-educational and fully accredited.

Our nine Catholic schools are:

- Charlotte Catholic High School (9-12)
- Christ the King Catholic High School (9-12)
- Holy Trinity Catholic Middle School (6-8)
- Our Lady of the Assumption (PK, K-8)
- St. Mark (K-8)
- St. Ann (PK, TK, K-5)
- St. Gabriel (K-5)
- St. Matthew (TK, K-5)
- St. Patrick (K-5)

At our schools, we build leaders with strong minds and an abiding faith in God. We emphasize academics, faith, and service in everything we do. We integrate the latest in technology throughout our curriculum. Our students think critically and serve their communities. They graduate as confident, well-spoken individuals with strong moral compasses. Our students are successful due to our faith-based college preparatory curriculum, which has resulted in a 100 percent graduation rate. No matter the path they choose, our graduates leave with a strong work ethic, a desire to achieve excellence, and a faith-filled heart to serve.





100%
graduation
and college
matriculation rates



50+
academic,
technology, and
specialty courses



125+
North Carolina High
School Athletic
Association
championships
since 2001



10,000
student service
hours performed
in 2017

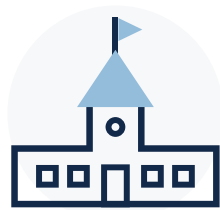

9
co-ed, fully
accredited
MACS schools



4
languages taught



4
special learning
programs



25+
fine arts courses
offered

MACS established a capital fee in 1992 that is paid annually by each school family. The capital fee has helped to finance the construction and renovation of our schools for almost 30 years, with more than \$67 million invested in our schools since 1992. The major additions and renovations include:



- New construction of Our Lady of the Assumption
- Extensive renovations at St. Patrick
- Extensive renovations at St. Ann
- Purchase of an office building on Highway 51 and conversion to CCHS
- Renovation of the old CCHS campus into the new Holy Trinity Catholic Middle School
- New construction of St. Mark
- New construction St. Matthew
- New construction of Christ the King Catholic High School
- New parking deck construction and stadium renovations at CCHS
- Renovations at Holy Trinity
- Holy Trinity classroom addition
- Holy Trinity gym and cafeteria improvements

MACS



HONORING THE TRADITION

Charlotte Catholic is rooted in an educational program that began in 1887 as St. Mary’s Seminary, led by the Sisters of Mercy and located downtown beside St. Peter Catholic Church. Growth at St. Mary’s led to the founding of the O’Donoghue School. Continued growth led to relocation of grades 9-12 to a new campus on Park Road in 1955, which was named Charlotte Catholic High School. Our Lady of Mercy was created as an all-girls high school in 1961, but the boys’ and girls’ schools were rejoined in 1968, once again as Charlotte Catholic High School, and led by the Sisters of Mercy. Enrollment continued to increase, and in 1995, CCHS relocated to its current location on Highway 51.

Our tradition of great community support has led directly to our growth and success. Our generous supporters and our parishes provide vital tuition assistance and support for our schools. As we continue to provide our students with the best possible Catholic education, please know that we are grateful for the many ways that you make our Catholic schools a better place.



OUR MISSION
Charlotte Catholic High School is an educational community centered in the Roman Catholic faith, which teaches individuals to serve as Christians in our changing world.

Since Charlotte Catholic High School relocated to its current campus, our Catholic community has recognized the need for a dedicated space for the performing and visual arts that would fully serve our students along their educational journey.

KEY PLANNING MILESTONES

The master plan developed for CCHS includes a fine arts center.

1994

CCHS moved to its new location on Pineville-Matthews Road.

1995

Renovations at CCHS include the media center expansion, addition of 16 classrooms, cafeteria expansion, custodial/storage expansion, and the addition of the Chapel.

2001-2003

The updated site plan for the fine arts center at CCHS is developed.

2008



EXPANDING THE VISION

Long-range planning and the positive findings of our campaign planning study have allowed us to develop a vision to best fulfill our mission now and into the future. The *Expanding the Vision, Honoring the Tradition* Capital Campaign captures our vision and will truly transform our future, shaping not only current and future students, but the entire Charlotte Catholic community.

Today, our schools offer everything from chorus to band to theater to the visual arts. Our students consistently secure local, regional, and national recognition for excellence in the arts. While our programs thrive, the space to support our students' development of their God-given talents remains limited. To fulfill our mission and address these needs, we must provide a fine arts center that will be used by all MACS students and available to the broader community.

Our plans provide a beautiful 21st century building where our students can refine and demonstrate their skills in the visual and performing arts. All fine arts classes will relocate to this new building, freeing up existing spaces that will be renovated for classroom use and for athletics. Plans include a new weight room, a new wrestling room, and classrooms for teachers who currently do not have them. We then can ensure a well-rounded high school experience for ALL of our students.

MACS approves the construction of the parking deck and the stadium renovation at CCHS.

2013

The parking deck opens at CCHS. The Pre-Campaign Plan for the MACS Fine Arts Center is developed.

2015

First meeting of the Pre-Campaign Planning Committee.

2016

Campaign planning study is completed.

2018



MACS FINE ARTS CENTER AT CHARLOTTE CATHOLIC HIGH SCHOOL

Mecklenburg Area Catholic Schools and Charlotte Catholic High School have established a Campaign Goal to successfully complete the MACS Fine Arts Center at Charlotte Catholic High School.

CAMPAIGN GOAL \$8 MILLION

MACS CAPITAL FEE CONTRIBUTION \$15 MILLION

TOTAL INVESTMENT
IN OUR SCHOOLS \$23 MILLION

Combined with the MACS Capital Fee contribution of \$15 million, reaching the \$8 million Campaign Goal will provide a total investment of \$23 million. This will complete both Phase 1 and Phase 2 of the Fine Arts Center construction.

Phase 1 Phase 1 will construct a new Theater, Band Room, Choral Room, Concessions Space, Drama Classroom, Dance Studio, Ensemble Room, Lobby, and Set Construction Space, plus Dressing Rooms, Side Stages, and more.

Phase 2 Phase 2 will construct Art Studios, a Black Box Catwalk, a Digital Lab, a Ceramics Studio, Faculty Workshop Space, a Photography Lab, a 60' Fly Tower, and more.

When our fine arts classes relocate to the new building, existing spaces in the current school building will be freed up. These spaces will be renovated for classroom use and for athletics. Plans include a new Weight Room, a new Wrestling Room, and classrooms for teachers who currently do not have them.



CAMPAIGN C

NEW FACILITY



- Phase 1
- Phase 2

CCHS RENOVATION

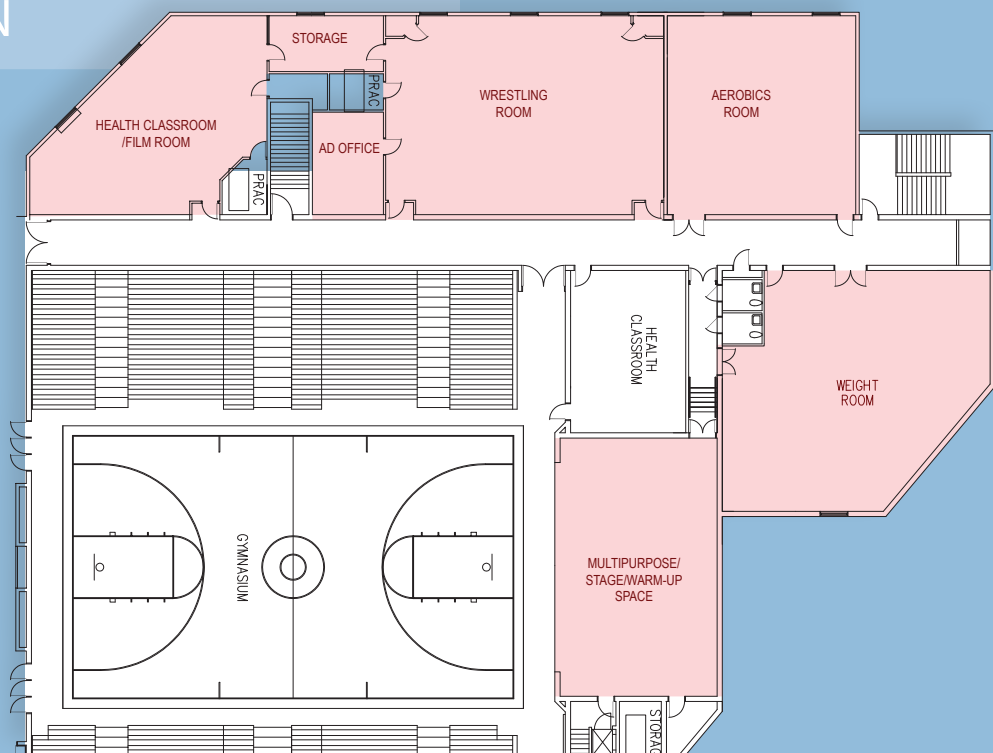

GOAL

WAYS TO GIVE

We hope you will choose to support the campaign in a way that makes sense for your personal financial situation and goals. Tax laws are always changing, so we encourage you to consult with your personal financial planner to determine a method of giving that is appropriate for your unique situation.

We will give every member of our extended Catholic family an opportunity to support the *Expanding the Vision, Honoring the Tradition* Capital Campaign, through a variety of methods:

➞ *Pledges: Most donors will choose to make a pledge over the three-year pledge period. These pledges will be payable in cash, through electronic fund transfer, or by credit card. This commitment can be fulfilled through monthly, quarterly, semi-annual, or annual installments.*

Appreciated Stocks and Securities: Giving securities that have increased in value may allow you to take the current market price as a tax deduction. You will owe no income tax or capital gains tax on the increase.

Real Estate: Gifts of real estate, including personal residences, vacation homes, commercial properties, farms, and unimproved land, may provide exceptional tax benefits for the donor while providing support for the school. Gifts of real estate will be considered on a case by case basis.

Estate Gifts or Bequests: Please notify the campaign office if you have already included or plan to include the school in your estate plans. Wills, trusts, or retirement plans, can be an advantage both to you and to our schools.



GIFTS NEEDED \$8 MILLION

GIFT RANGE	NO. GIFTS REQUIRED	SUBTOTAL	CUMULATIVE TOTAL	CUMULATIVE %
\$1,000,000	1	\$1,000,000	\$1,000,000	13%
\$750,000	1	\$750,000	\$1,750,000	9%
\$500,000	2	\$1,000,000	\$2,750,000	13%
\$250,000	3	\$750,000	\$3,500,000	9%
\$100,000	6	\$600,000	\$4,100,000	8%
\$75,000	10	\$750,000	\$4,850,000	9%
\$50,000	14	\$700,000	\$5,550,000	9%
\$30,000	22	\$660,000	\$6,210,000	8%
\$15,000	33	\$495,000	\$6,705,000	6%
\$9,000	50	\$450,000	\$7,155,000	6%
\$6,000	67	\$402,000	\$7,557,000	5%
\$3,000	98	\$294,000	\$7,851,000	4%
Under \$1,500	1,500+	\$149,000	\$8,000,000	2%
TOTALS	1,807+	\$8,000,000	\$8,000,000	100%

BUDGETING YOUR GIFT

PLEDGE PAYMENT SCHEDULE - 3 YEARS

TOTAL GIFT	MONTHLY	QUARTERLY	SEMI-ANNUAL	ANNUAL
\$1,000,000	\$27,777.78	\$83,333.33	\$166,666.67	\$333,333.33
\$750,000	\$20,833.33	\$62,500.00	\$125,000.00	\$250,000.00
\$500,000	\$13,888.89	\$41,666.67	\$83,333.33	\$166,666.67
\$250,000	\$6,944.44	\$20,833.33	\$41,666.67	\$83,333.33
\$100,000	\$2,777.78	\$8,333.33	\$16,666.67	\$33,333.33
\$75,000	\$2,083.33	\$6,250.00	\$12,500.00	\$25,000.00
\$50,000	\$1,388.89	\$4,166.67	\$8,333.33	\$16,666.67
\$30,000	\$833.33	\$2,500.00	\$5,000.00	\$10,000.00
\$15,000	\$416.67	\$1,250.00	\$2,500.00	\$5,000.00
\$9,000	\$250.00	\$750.00	\$1,500.00	\$3,000.00
\$7,500	\$208.33	\$625.00	\$1,250.00	\$2,500.00
\$6,000	\$166.67	\$500.00	\$1,000.00	\$2,000.00
\$3,000	\$83.33	\$250.00	\$500.00	\$1,000.00

COMMEMORATIVE OPPORTUNITIES

MACS Fine Arts Center	\$5M	Signage on Building	Side Stages (2)	\$100K	Plaque
Theater	\$1M	Signage in Theater	Digital Lab	\$75K	Plaque
Lobby	\$750K	Signage in Lobby	Photography Lab	\$75K	Plaque
Band Room	\$500K	Plaque	Theater Dressing Rooms (2)	\$75K	Plaque
Stage	\$500K	Signage on Stage	Concessions	\$50K	Plaque
Choral Room	\$300K	Plaque	Dark Room	\$50K	Plaque
Dance Studio	\$250K	Plaque	Dance Dressing Rooms (2)	\$50K	Plaque
Multipurpose/Stage/Warm-Up Space	\$250K	Plaque	Ensemble Room	\$50K	Plaque
Weight Room	\$250K	Plaque	Health Classroom	\$50K	Plaque
Wrestling Room	\$250K	Plaque	Art Workroom	\$30K	Plaque
Aerobics Room	\$150K	Plaque	Athletic Director's Office	\$30K	Plaque
Art Studios (2)	\$150K	Plaque	Control Room	\$30K	Plaque
Balcony	\$150K	Signage on Balcony	Faculty Workroom	\$30K	Plaque
Drama Classroom	\$150K	Plaque	Kiln Room	\$30K	Plaque
Health Classroom/Film Room	\$150K	Plaque	Practice Rooms (4)	\$30K	Plaque
Ceramics Studio	\$100K	Plaque	Storage Room	\$30K	Plaque

CCHS LEADERSHIP

Kurt Telford

Principal

Sally McArdle

Executive Director of Advancement

DIOCESAN LEADERSHIP

Jim Kelley

Development Director

HONORARY CHAIRS

Sister Paulette Williams

CCHS Principal 1980-2000

Norm George

Mary Ann Grace

Jim Keffer

Joan & Stanley F. Michalski, Jr.

Kathy Mulvaney

Joan & Paul Polking

Jim Sigman

GENERAL CHAIRS

Carolyn Culicerto Corsi

& John Corsi

Rich Hoefling

Tish & Brian Macuga

CAMPAIGN CABINET

Jay Bryson

Lennie Cox

Donna & Gary Green

Cindy Grim

Katie & Bryan Hodgins

Benne Hutson

Eric Kammerer

Steffan & Chris Kelly

Paul Peralta

Shannon Roderick

Sara Garces Roselli

Leslie Tesch

London & Doug Thornton

CAMPAIGN COUNSEL

Steier Group



**CHARLOTTE CATHOLIC
HIGH SCHOOL**

7702 Pineville-Matthews Road
Charlotte, NC 28226